

Tel: 966 12 684 8046
966 12 684 8959
Fax: 966 12 640 5622
AFS OEJDYKYX
<http://www.sans.com.sa>
E-mail: aim@sans.com.sa

KINGDOM OF SAUDI ARABIA
GENERAL AUTHORITY OF CIVIL AVIATION
SAUDI AIR NAVIGATION SERVICES
AERONAUTICAL INFORMATION MANAGEMENT
P. O. BOX 929, JEDDAH - 21421

**AIP
SUP
AIP SUP 06/25
02 FEB 2025**

**RIYADH / KING KHALED INTL AIRPORT – (OERK)
RWY 15L/33R & 15R/33L Pavement Maintenance, Airfield Ground Lights Replacement at Western Taxi-
ways/Aprons Project, and TWY A Resurfacing Project**

1 Introduction:

This AIP supplement provides flight crews, operators, concerned personnel and stakeholders with detailed information and an overview of the operational impact and restrictions resulted from the execution of the maintenance activities on both runways (15L/33R & 15R/33L), TWY A resurfacing project and replacing the airfield ground lights at Western taxiways and aprons.

2 Timeline and Activation:

The projects will be completed within 23 weeks and have been divided into 15 phases where each phase will be activated and announced through NOTAMs.

- Note: Phases 1-5 were executed in advance with its associated NOATM/Publications as the following:

1. Phase 1: Works on TWY H3 intersection TWY H.
2. Phase 2: Works on portion of RWY 15L/33R abeam H1
3. Phase 3: Works on portion of RWY 15L/33R abeam H4
4. Phase 4: Works on:
 - RWY 15L/33R full closure.
 - Portion of TWY H3 between RWY 15L/33R and TWY H.
 - Portion TWY E between TWY N and TWY P)
5. Phase 5: Works on portion of TWY H3 between RWY 15L/33R and TWY H.

3 Purpose of the Projects:

- Runways' pavement maintenance.
- AGLs upgrading from Halogen to LED.
- Maintaining Compliant Spacing between AGLs.
- Installation of LED signages in several locations.
- Intersection Take off Run Available (TORA) Signage installation.
- Resurfacing TWY A.
- Expanding TWY A fillets.

4 Replacement or Cancellation of the AIP SUP:

The supplement will be replaced if significant change to the published information is expected.

5 Affected Areas and Operational Restrictions:

Phase 6A	
Closed Areas	- RWY 15R/33L. - Portion TWY P from TWY E excluding the intersection to the holding position of RWY 15R/33L through TWY A5. - TWY A from TWY A5 including the intersection to the HLDP of RWY 15R.
Duration	+ 14 Days
Phase Activation	- NOTAM will be issued to highlight the phase activation.
Operational Procedures and Restrictions	- TWY T will be the only link between commercial and secondary taxiways.
Associated Layout	Appendix 1

Phase 6B	
Closed Areas	- TWY P from TWY E excluding the intersection to the holding position of RWY 15R/33L through TWY A5. - TWY A from TWY A5 including the intersection to the HLDP of RWY 15R.
Duration	+ 5 Days
Phase Activation	- NOTAM will be issued to highlight the phase activation.
Operational Procedures and Restrictions	- TWY T will be the only link between commercial and secondary taxiways. - RWY 33 in use: <ul style="list-style-type: none"> • Runway (15R/33L) will be used for departures. • RWY 15L/33R will be used for arrivals. - RWY 15 in use: <ul style="list-style-type: none"> • RWY 15R/33L will be used for landing. • RWY 15L/33R will be used for departure.
Associated Layout	Appendix 2

Phase 7	
Closed Areas	- Portion TWY P between TWY A and TWY E excluding both intersections. - TWY A from TWY A5 excluding the intersection to the HLDP of RWY 15R.
Duration	+ 8 Days
Phase Activation	- NOTAM will be issued to highlight the phase activation.
Operational Procedures and Restrictions	- TWY T will be the only link between commercial and secondary taxiways. - RWY 33 in use: <ul style="list-style-type: none"> • Runway (15R/33L) will be used for departures. • RWY 15L/33R will be used for arrivals. • The decision to land on RWY 15R/33L will remain available for arriving aircraft at the pilot's discretion as the LDA will remain the same; however, aircraft must vacate max through TWY A5. - RWY 15 in use: <ul style="list-style-type: none"> • RWY 15R/33L will be used for landing. • RWY 15L/33R will be used for departure.
Associated Layout	Appendix 3

Phase 8	
Closed Areas	- TWY A from TWY A6 excluding the intersection to the HLDP of RWY 15R.
Duration	+15 Days
Phase Activation	NOTAM will be issued to highlight the phase activation.
Operational Procedures and Restrictions	<p>RWY 33 in use:</p> <ul style="list-style-type: none"> • Runway (15R/33L) will be used for departures. • RWY 15L/33R will be used for arrivals. • The decision to land on RWY 15R/33L will remain available for arriving aircraft at the pilot's discretion as the LDA will remain the same; however, aircraft must vacate max through TWY A6. <p>- RWY 15 in use:</p> <ul style="list-style-type: none"> • RWY 15R/33L will be used for landing. • RWY 15L/33R will be used for departure.
Associated Layout	Appendix 4

Phase 9	
Closed Taxiways / Aprons	- Portion TWY T between TWY D excluding the intersection to the HLDP of RWY 33L through TWY A2 - TWY A from TWY A2 including the intersection to the HLDP of RWY 33L.
Duration	+ 14 Days
Phase Activation	NOTAM will be issued to highlight the phase activation.
Operational Procedures and Restrictions	<p>- TWY P will be the only link between commercial and secondary taxiways.</p> <p>- RWY 33 in use:</p> <ul style="list-style-type: none"> • Runway (15R/33L) will be used for arrival. • RWY 15L/33R will be used for departure. <p>- RWY 15 in use:</p> <ul style="list-style-type: none"> • RWY 15R/33L will be used for departure. • RWY 15L/33R will be used for landing. • The decision to land on RWY 15R/33L will remain available for arriving aircraft at the pilot's discretion as the LDA will remain the same; however, aircraft must vacate max through TWY A3.
Associated Layout	Appendix 5

Phase 10	
Closed Taxiways / Aprons	- TWY T between TWY D and TWY A excluding both intersections - TWY A from TWY A2 excluding the intersection to the HLDP of RWY 33L.
Duration	+ 10 Days
Phase Activation	- NOTAM will be issued to highlight the phase activation.
Operational Procedures and Restrictions	<p>- RWY 33 in use:</p> <ul style="list-style-type: none"> • Runway (15R/33L) will be used for arrival. • RWY 15L/33R will be used for departure. <p>- RWY 15 in use:</p> <ul style="list-style-type: none"> • RWY 15R/33L will be used for departure. • RWY 15L/33R will be used for landing. • The decision to land on RWY 15R/33L will remain available for arriving aircraft at the pilot's discretion as the LDA will remain the same; however, aircraft must vacate max through TWY A2.
Associated Layout	Appendix 6

Phase 11	
Closed Taxiways / Aprons	- TWY A from TWY A2 excluding the intersection to the HLDP of RWY 33L
Duration	+ 10 Days
Phase Activation	- NOTAM will be issued to highlight the phase activation.
Operational Procedures and Restrictions	<p>RWY 33 in use:</p> <ul style="list-style-type: none"> • Runway (15R/33L) will be used for arrival. • RWY 15L/33R will be used for departure. <p>- RWY 15 in use:</p> <ul style="list-style-type: none"> • RWY 15R/33L will be used for departure. • RWY 15L/33R will be used for landing. • The decision to land on RWY 15R/33L will remain available for arriving aircraft at the pilot's discretion as the LDA will remain the same; however, aircraft must vacate max through TWY A2
Associated Layout	Appendix 7

Phase 12	
Closed Taxiways / Aprons	Portion TWY A from TWY A5 to TWY A3 excluding both intersections. - TWY J - APN 7B - APN7 - APN 8 except following stands: 55, G2, and 54
Duration	+30 Days
Phase Activation	- NOTAM will be issued to highlight the phase activation.
Operational Procedures and Restrictions	- Outbound traffic from stands: 55, G2, and 54 must be pushed facing north to clear TWY Q.
Associated Layout	Appendix 8

Phase 13	
Closed Taxiways / Aprons	- TWY J. - APN 7B. - APN7. - APN 8 except following stands: 55, G2, and 54.
Duration	+15 Days
Phase Activation	- NOTAM will be issued to highlight the phase activation.
Operational Procedures and Restrictions	- Outbound traffic from stands: 55, G2, and 54 must be pushed facing north to clear TWY Q.
Associated Layout	Appendix 9

Phase 14	
Closed Taxiways / Aprons	- Portion TWY A from TWY A2 to TWY A4 excluding both intersections. - TWY Q. - APN 9B. - APN 9. - APN 8 except following stands: 50,51,52, G1, and G3.
Duration	+30 Days
Phase Activation	NOTAM will be issued to highlight the phase activation.
Operational Procedures and Restrictions	- Outbound traffic from stand G1 must be pushed facing south to clear TWY J.
Associated Layout	Appendix 10

Phase 15	
Closed Taxiways / Aprons	- APN 8 except following stands: 50,51,52, G1, and G3 - TWY Q - APN 9B - APN 9
Duration	+15 Days
Phase Activation	NOTAM will be issued to highlight the phase activation.
Operational Procedures and Restrictions	- Outbound traffic from stand G1 must be pushed facing south to clear TWY J.
Associated Layout	Appendix 11

6 INQUIRIES

For any inquiries please contact:

<i>Yousef Ibrahim Alghamdi</i> Aerodrome Operations Manager Yighamdi@riyadhairports.com Tel: 0503300165 Riyadh Airports Company	<i>Abdulaziz Mohammed Alzahrani</i> Riyadh Tower Chief abalzahrani@sans.com.sa Tel: 0502700000 Saudi Air Navigation Services
<i>Aerodrome Operations Duty Manager</i> aodm@riyadhairports.com Tel: 0112219479 Riyadh Airports Company	<i>Riyadh Tower Supervisor</i> Tel: 0112211141 Saudi Air Navigation Services

AIP SUP 04/25 hereby replaced



Phase 6A - Appendix 1

Closed Areas:

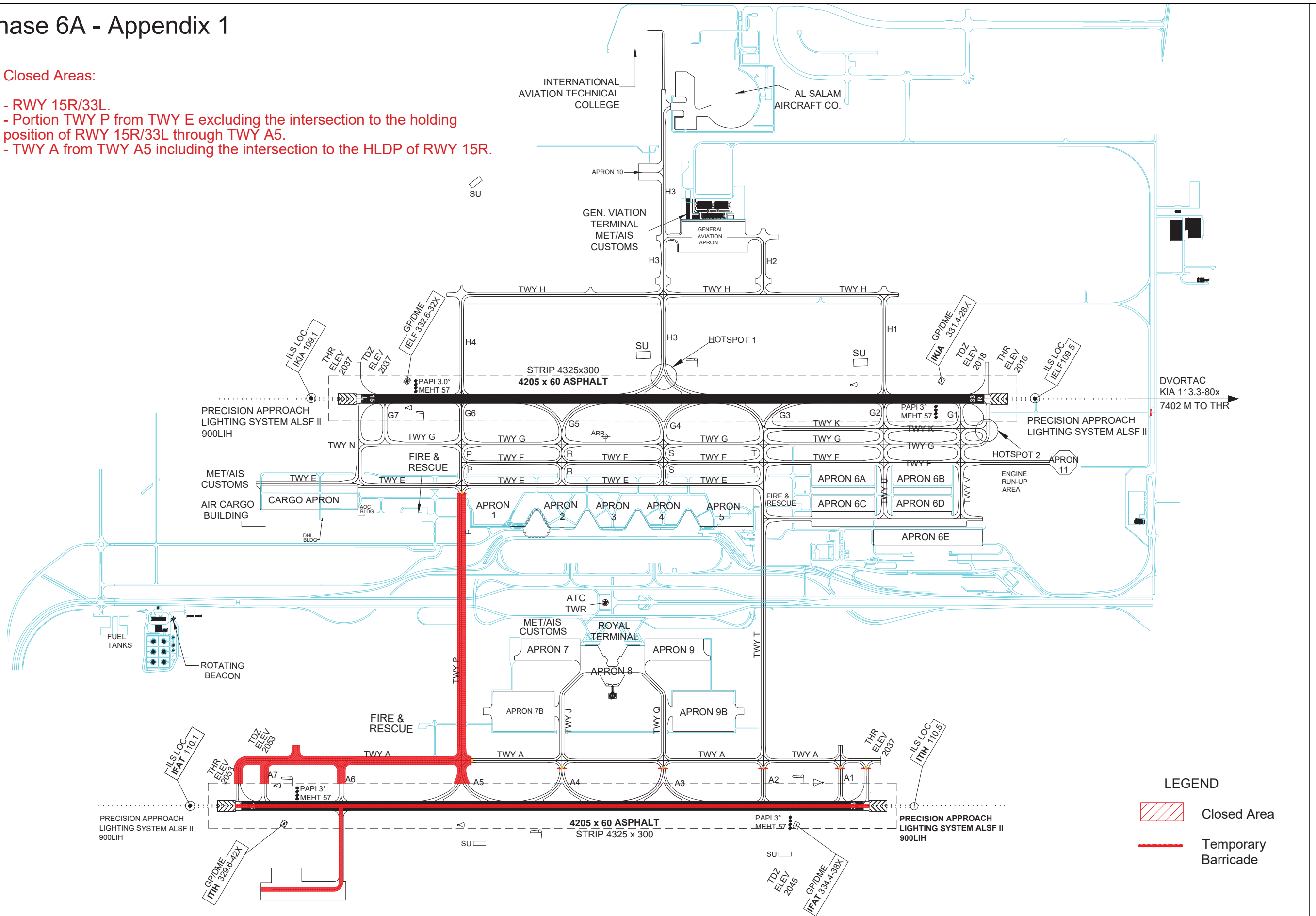
- RWY 15R/33L.
- Portion TWY P from TWY E excluding the intersection to the holding position of RWY 15R/33L through TWY A5.
- TWY A from TWY A5 including the intersection to the HLDP of RWY 15R.



LEGEND

-  Closed Area
-  Temporary Barricade

THIS PAGE
INTENTIONALLY
LEFT BLANK



Phase 6B - Appendix 2

Closed Areas:

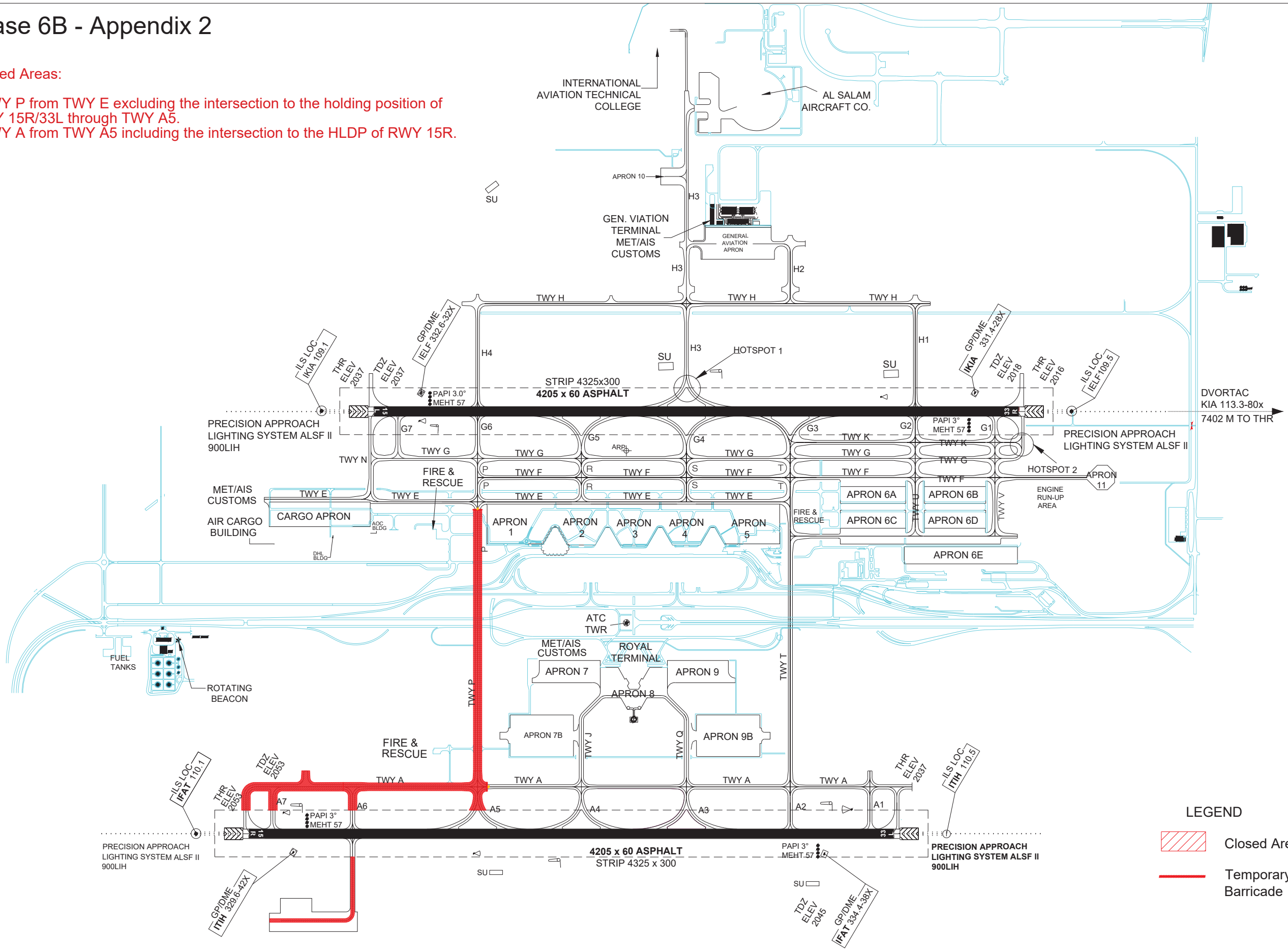
- TWY P from TWY E excluding the intersection to the holding position of RWY 15R/33L through TWY A5.
- TWY A from TWY A5 including the intersection to the HLDP of RWY 15R.



LEGEND

-  Closed Area
-  Temporary Barricade



THIS PAGE
INTENTIONALLY
LEFT BLANK

PHASE 7 - APPENDIX 3

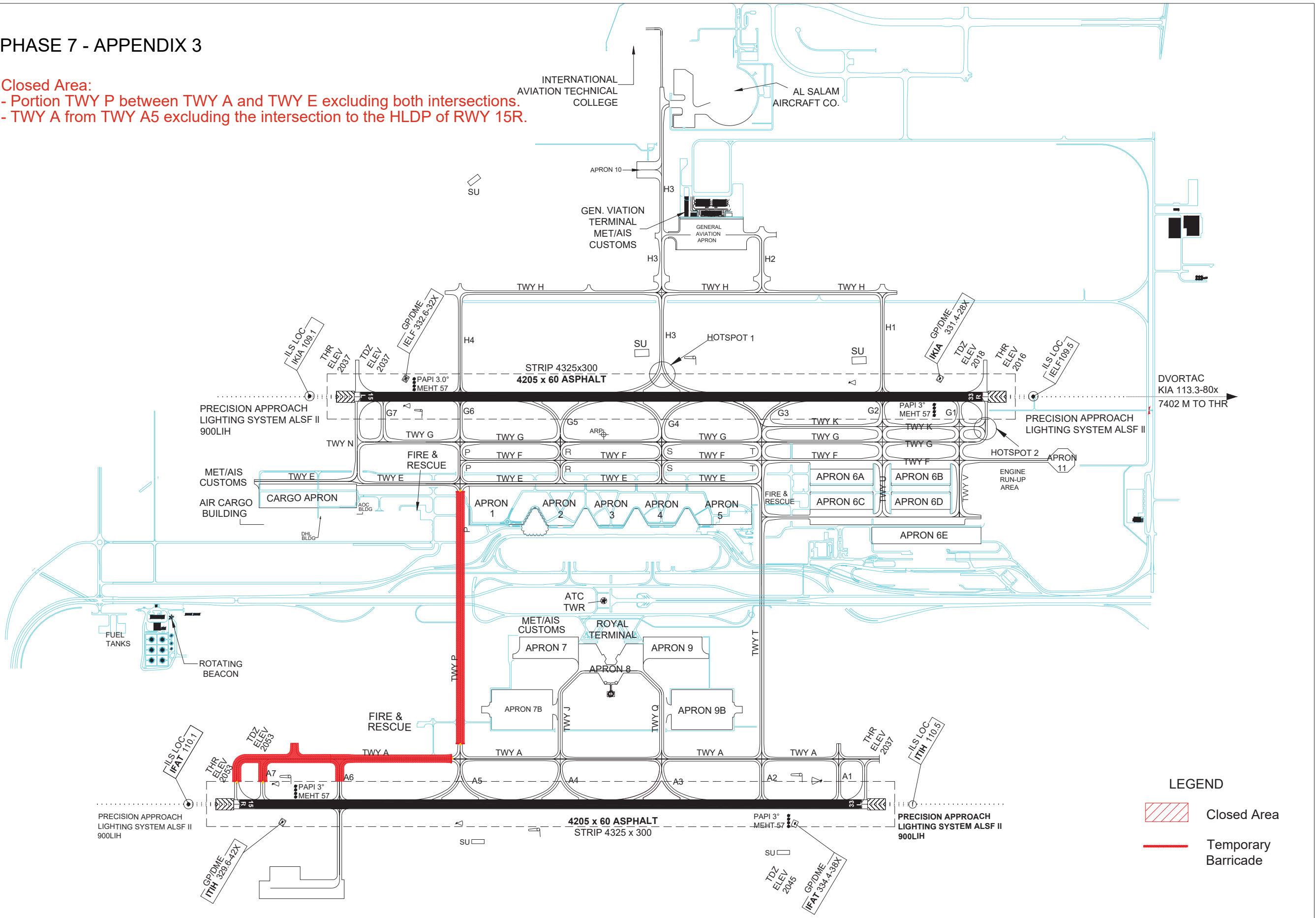
- Closed Area:**
- Portion TWY P between TWY A and TWY E excluding both intersections.
 - TWY A from TWY A5 excluding the intersection to the HLDP of RWY 15R.



LEGEND

-  Closed Area
-  Temporary Barricade

THIS PAGE
INTENTIONALLY
LEFT BLANK



Phase 8 - Appendix 4

Closed Areas:

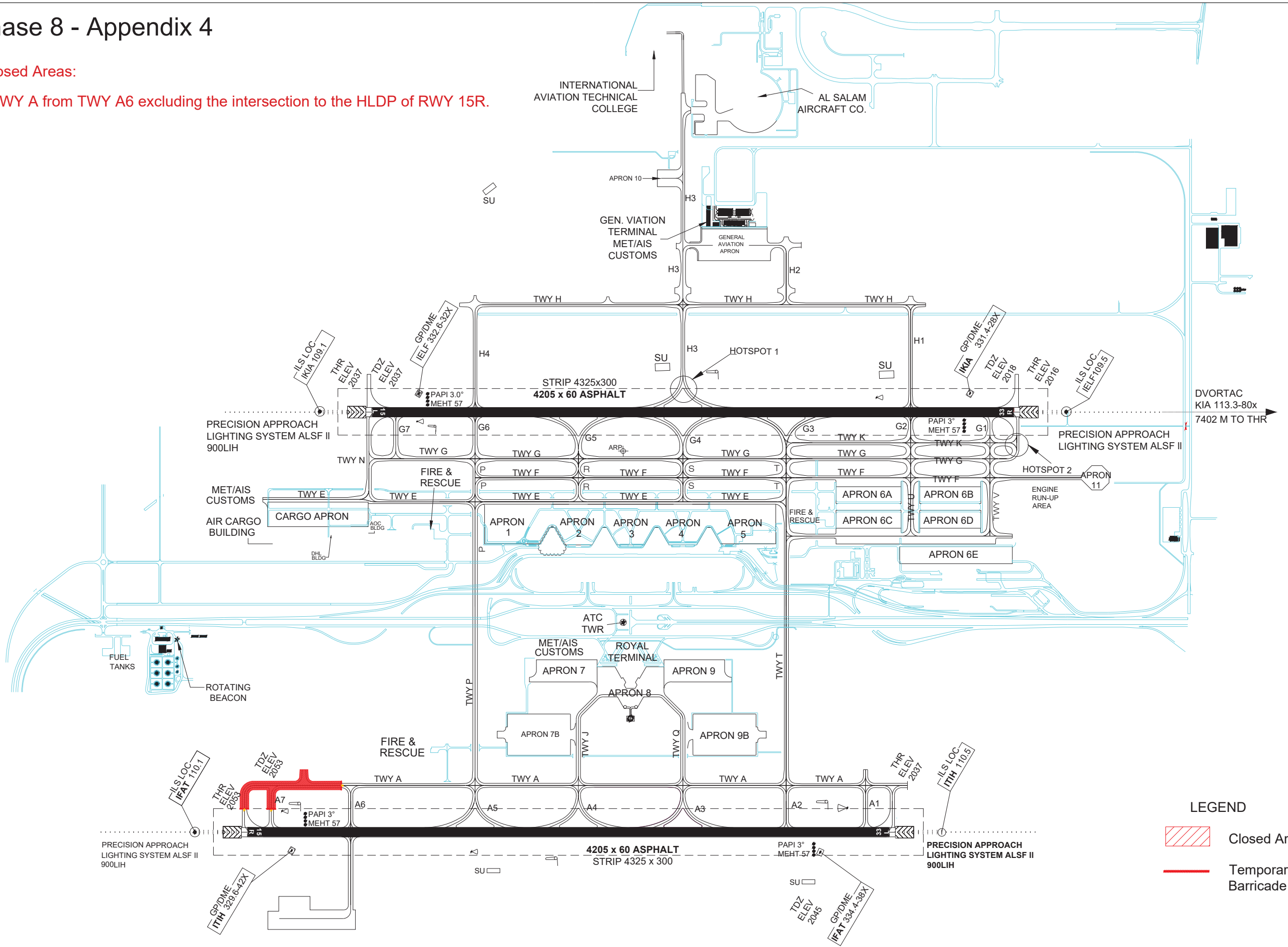
- TWY A from TWY A6 excluding the intersection to the HLDP of RWY 15R.



LEGEND

-  Closed Area
-  Temporary Barricade

THIS PAGE
INTENTIONALLY
LEFT BLANK



Phase 9 - Appendix 5

Closed Taxiways / Aprons:

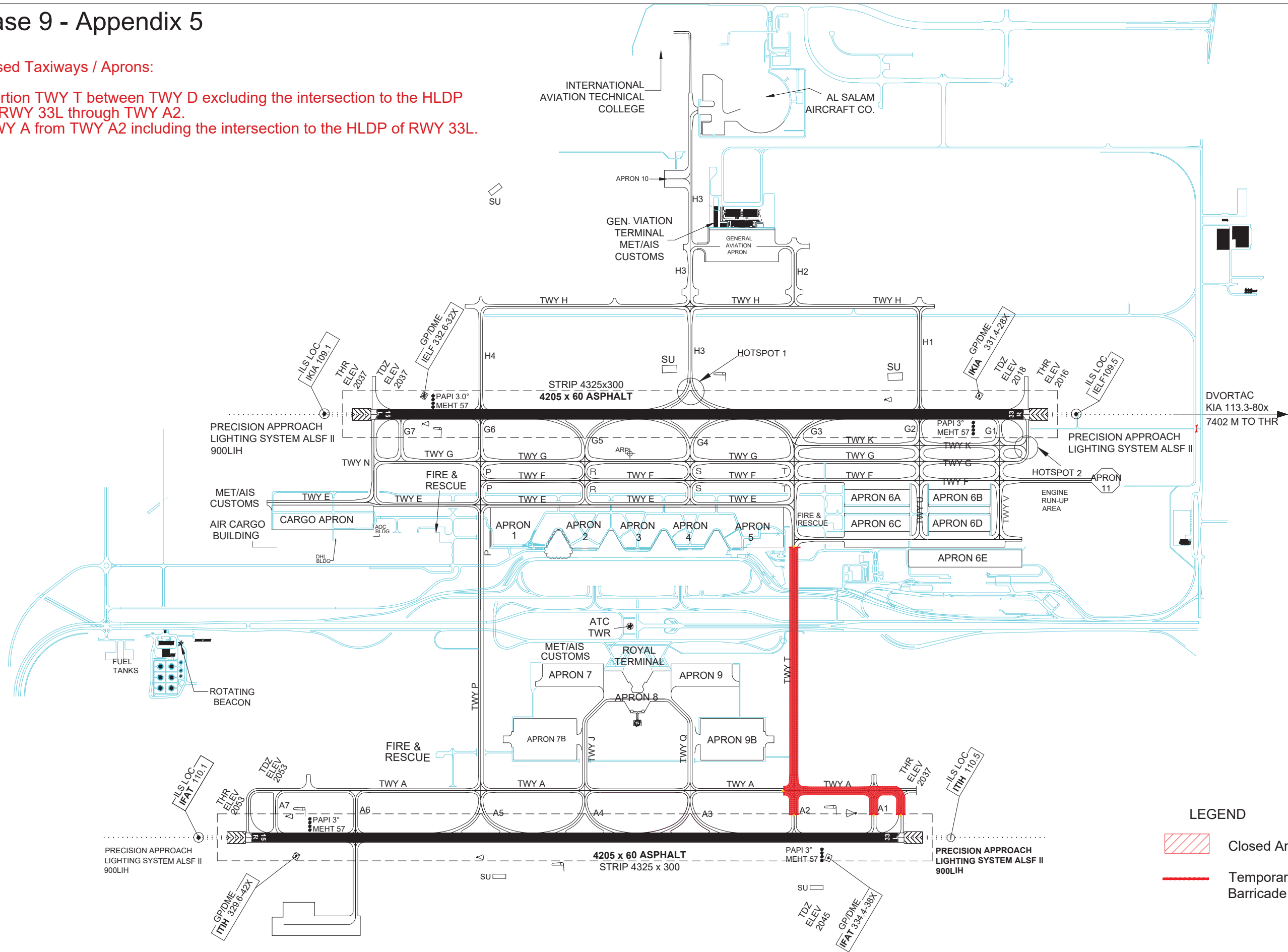
- Portion TWY T between TWY D excluding the intersection to the HLDP of RWY 33L through TWY A2.
- TWY A from TWY A2 including the intersection to the HLDP of RWY 33L.



LEGEND

-  Closed Area
-  Temporary Barricade

THIS PAGE
INTENTIONALLY
LEFT BLANK



Phase 10 - Appendix 6

Closed Taxiways / Aprons:

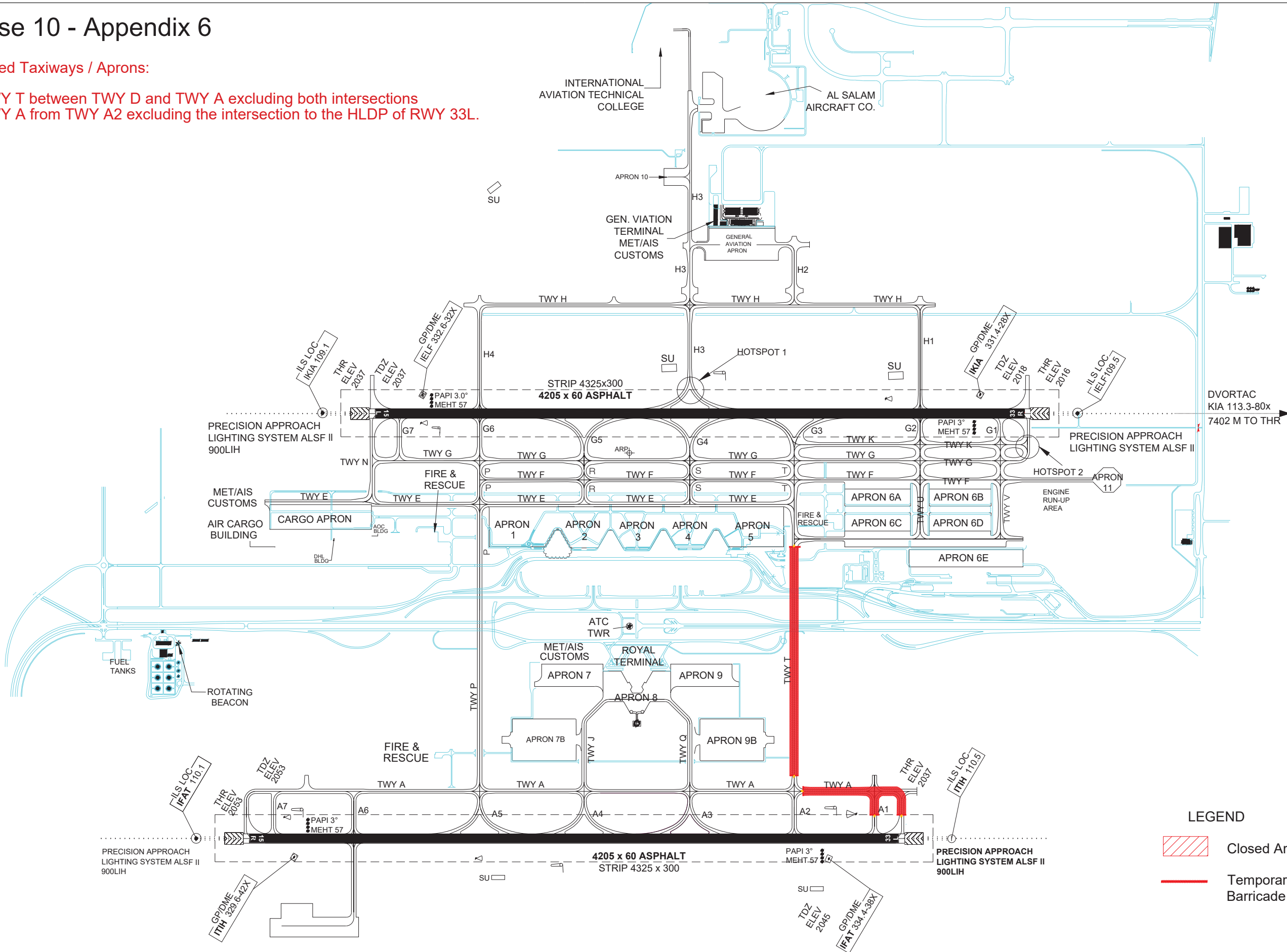
- TWY T between TWY D and TWY A excluding both intersections
- TWY A from TWY A2 excluding the intersection to the HLDP of RWY 33L.



LEGEND

-  Closed Area
-  Temporary Barricade

THIS PAGE
INTENTIONALLY
LEFT BLANK



Phase 11 - Appendix 7

Closed Taxiways / Aprons:

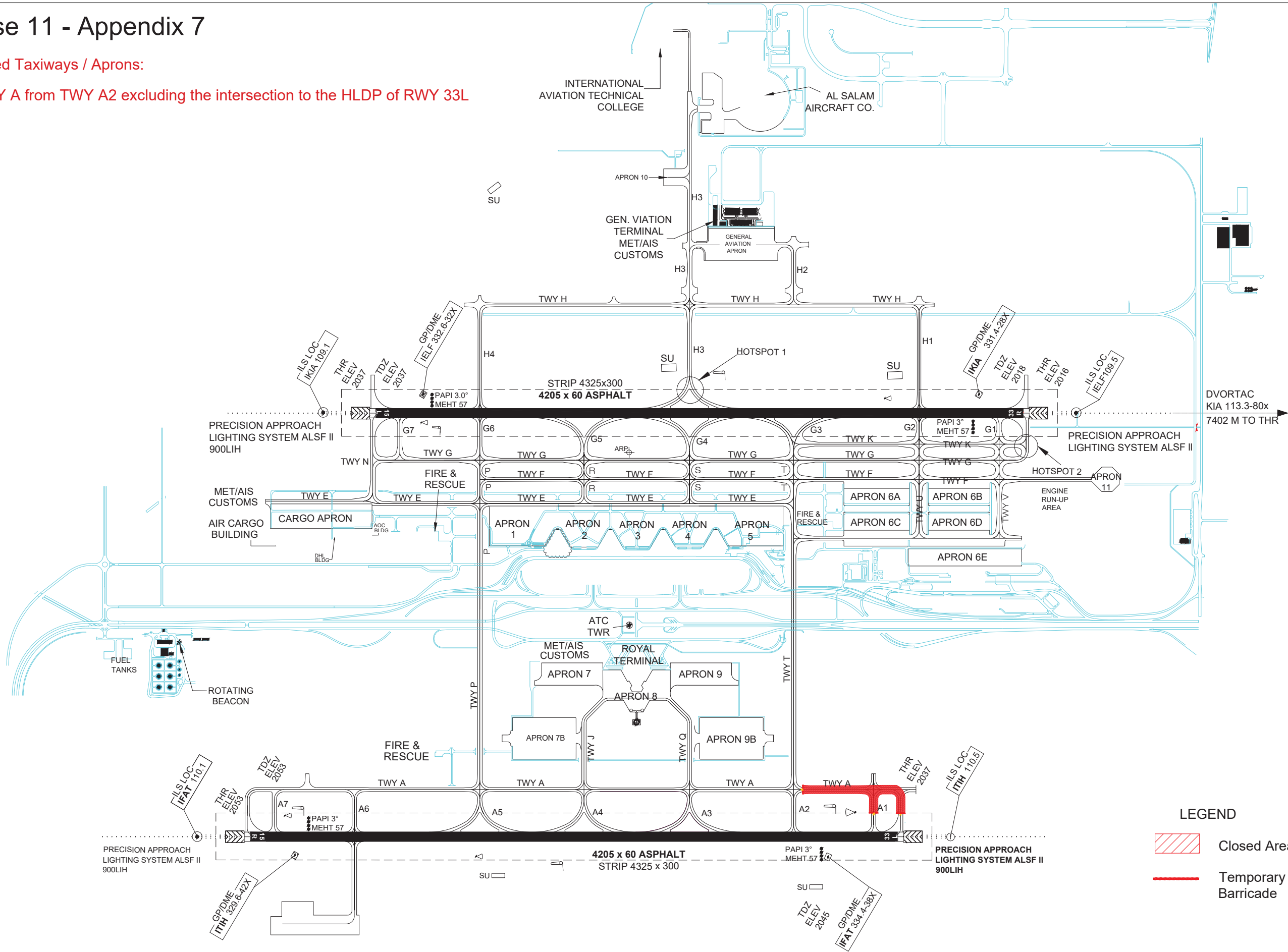
- TWY A from TWY A2 excluding the intersection to the HLD of RWY 33L



LEGEND

-  Closed Area
-  Temporary Barricade

THIS PAGE
INTENTIONALLY
LEFT BLANK



Phase 12 - Appendix 8

Closed Taxiways / Aprons:

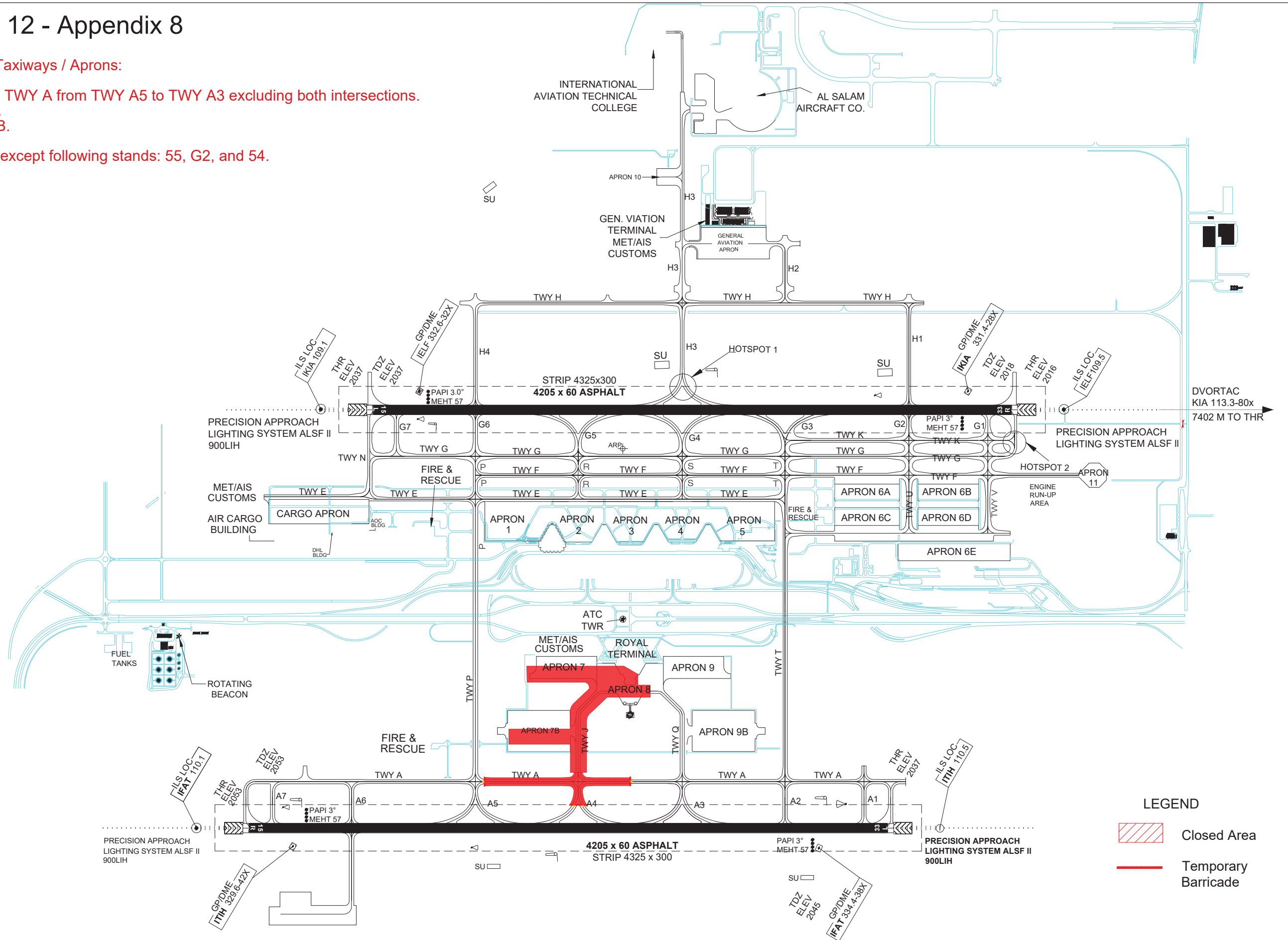
- Portion TWY A from TWY A5 to TWY A3 excluding both intersections.
- TWY J.
- APN 7B.
- APN 7.
- APN 8 except following stands: 55, G2, and 54.



LEGEND

-  Closed Area
-  Temporary Barricade

THIS PAGE
INTENTIONALLY
LEFT BLANK



Phase 13 - Appendix 9

Closed Taxiways / Aprons:

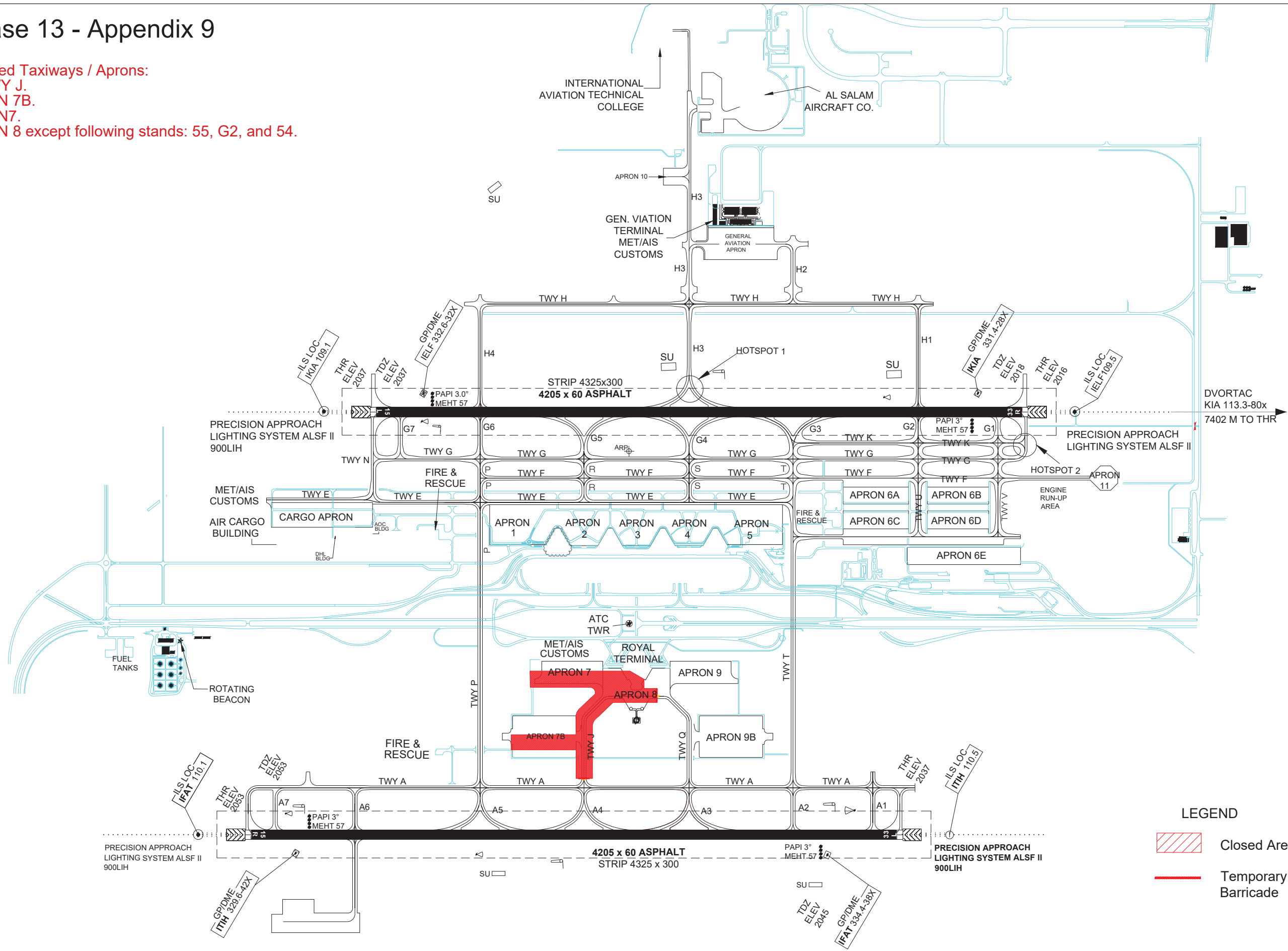
- TWY J.
- APN 7B.
- APN7.
- APN 8 except following stands: 55, G2, and 54.



LEGEND

-  Closed Area
-  Temporary Barricade

THIS PAGE
INTENTIONALLY
LEFT BLANK



Phase 14 - Appendix 10

Closed Taxiways / Aprons:

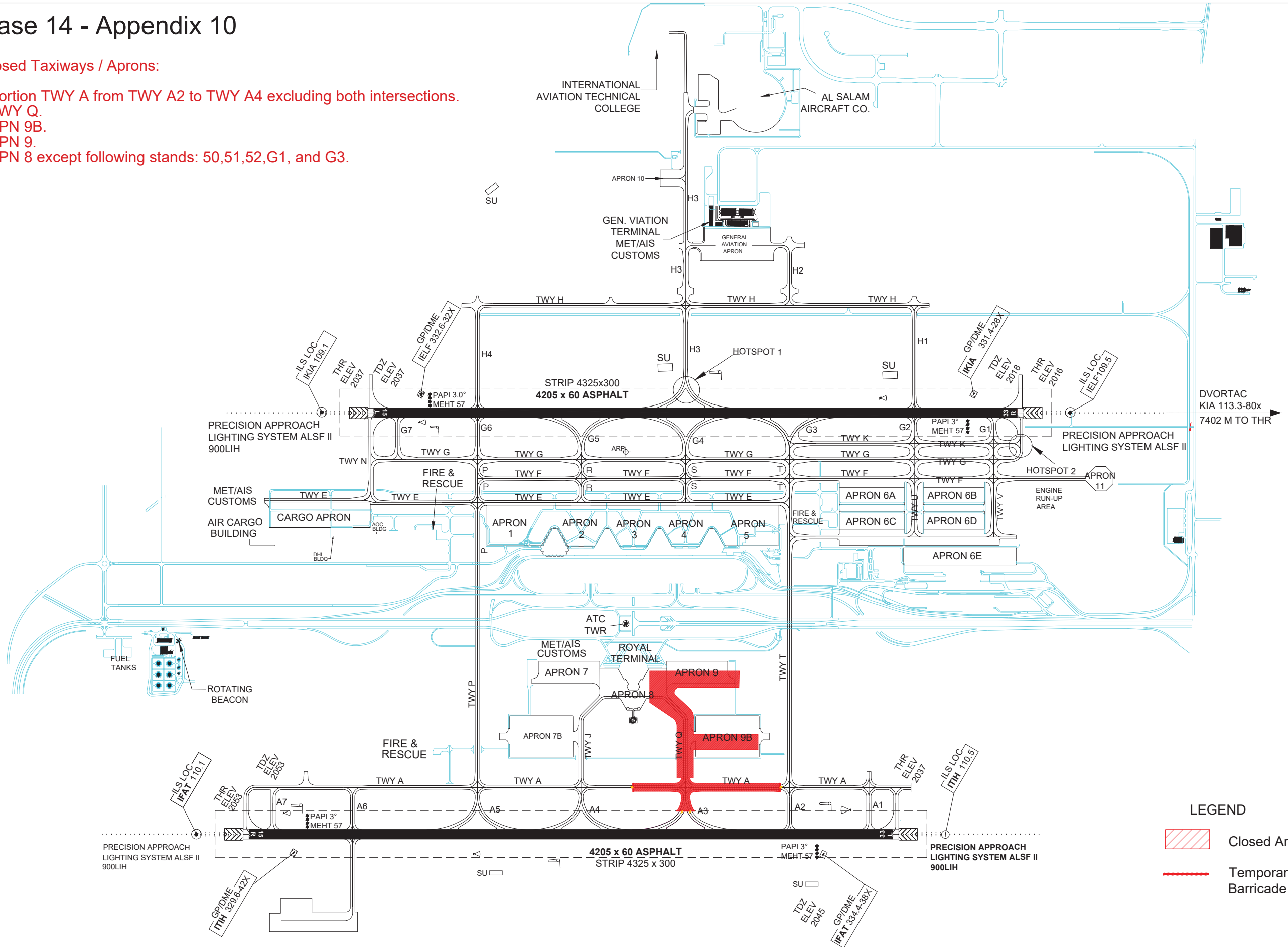
- Portion TWY A from TWY A2 to TWY A4 excluding both intersections.
- TWY Q.
- APN 9B.
- APN 9.
- APN 8 except following stands: 50,51,52,G1, and G3.



LEGEND

-  Closed Area
-  Temporary Barricade

THIS PAGE
INTENTIONALLY
LEFT BLANK



Phase 15 - Appendix 11

Closed Taxiways / Aprons:

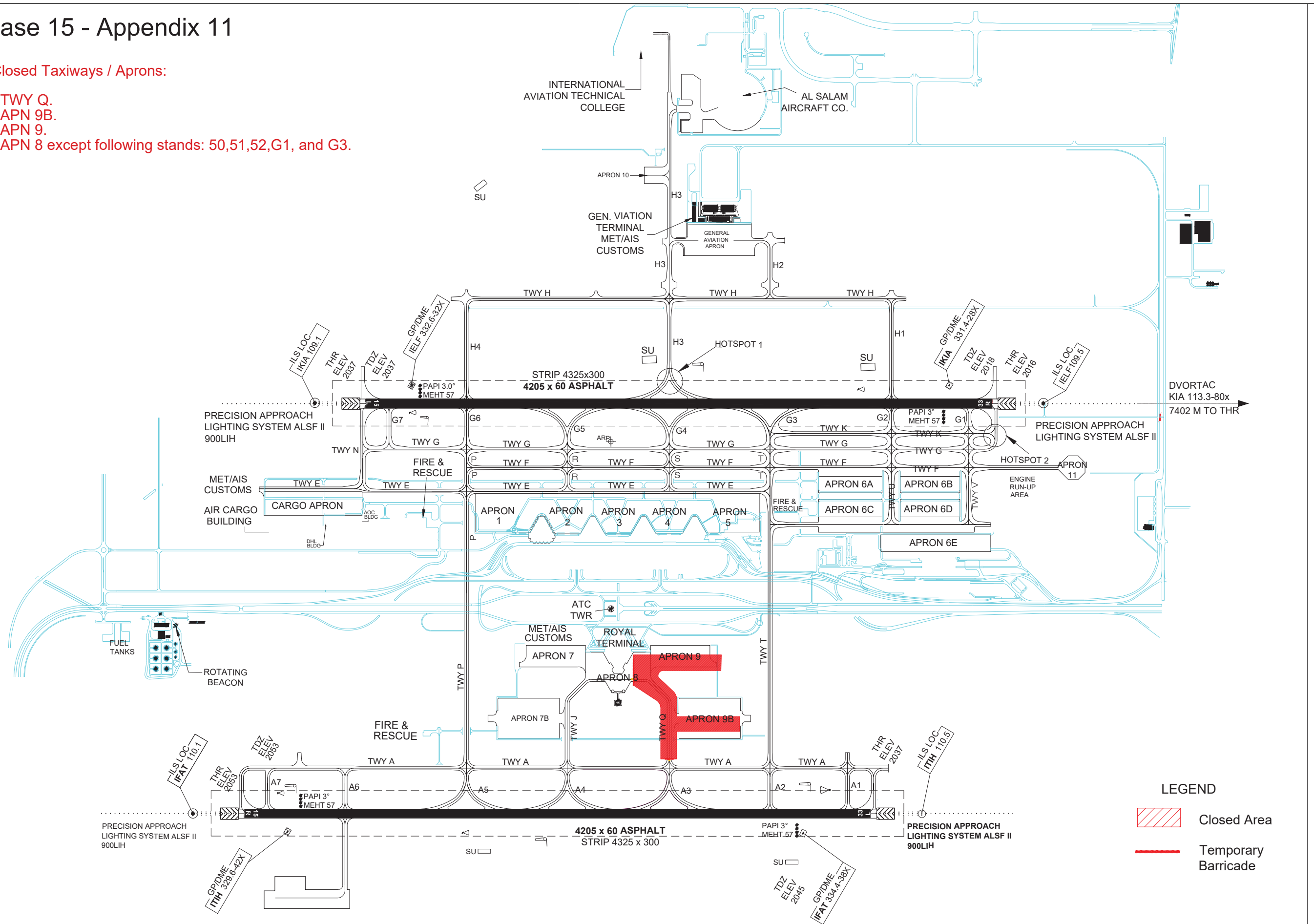
- TWY Q.
- APN 9B.
- APN 9.
- APN 8 except following stands: 50,51,52,G1, and G3.



LEGEND

-  Closed Area
-  Temporary Barricade